

Two of several possible
set-up arrangements:

Cocktails for 45

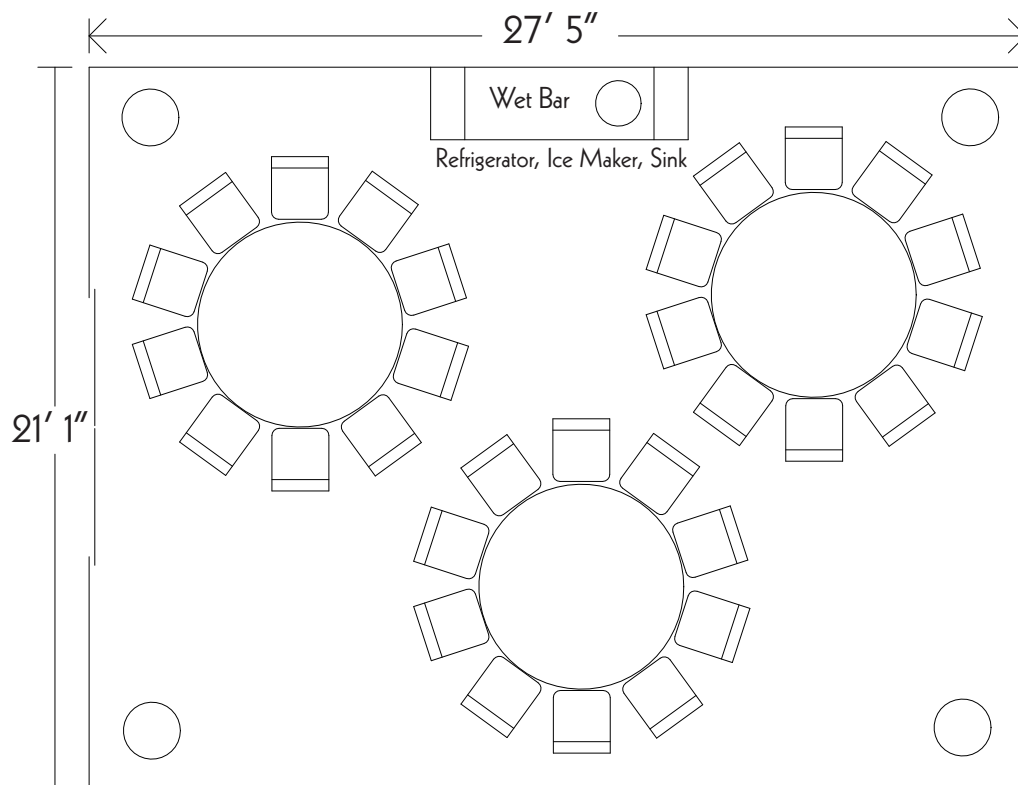

Seated dinner for 30,
3 72-inch rounds

THE SUE & EARL SWENSSON PATRON ROOM
The Noah Liff Opera Center



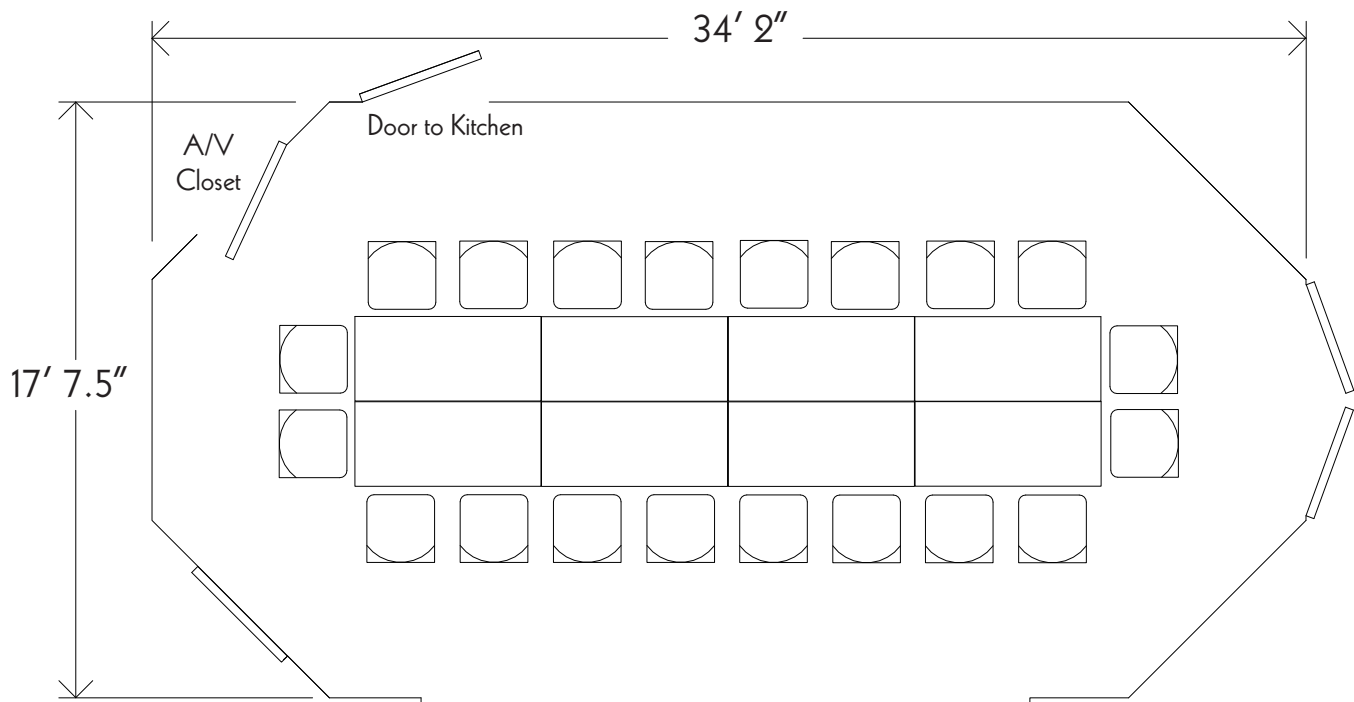

The Frist Foundation Board Room features an audio/video system with drop-down projector and screen perfect for meetings and seminars. Its sleek wood appointments and sparkling chandelier make it an intimate setting for dinners as well.

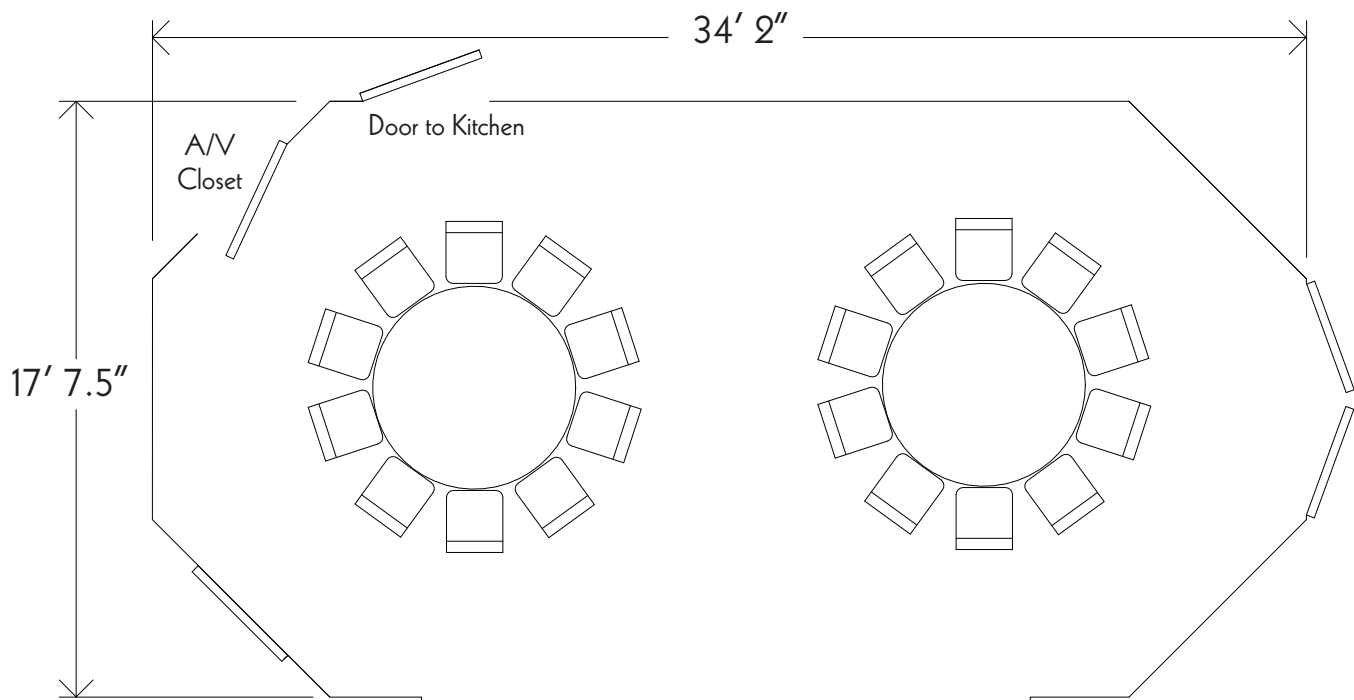

THE FRIST FOUNDATION BOARD ROOM

The Noah Liff Opera Center



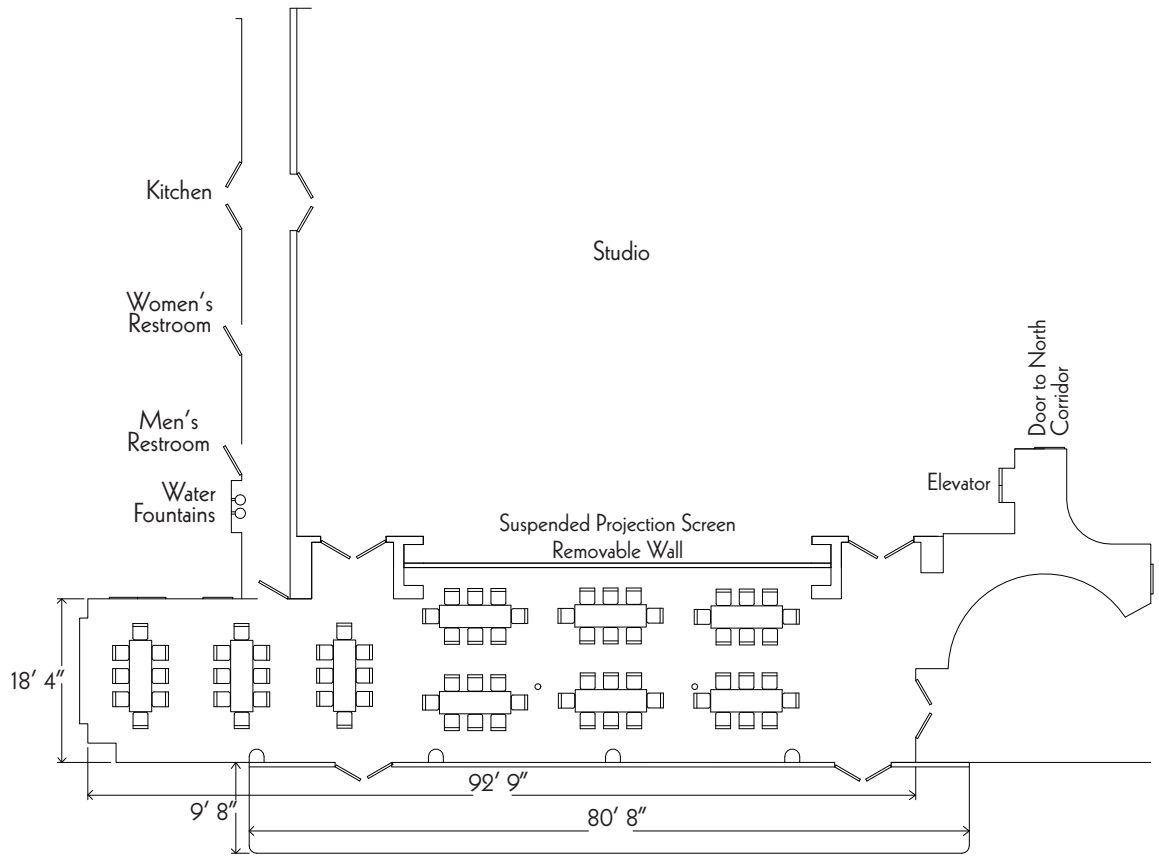

Two potential dinner party set-ups in the Ragsdale Family Grand Lobby.

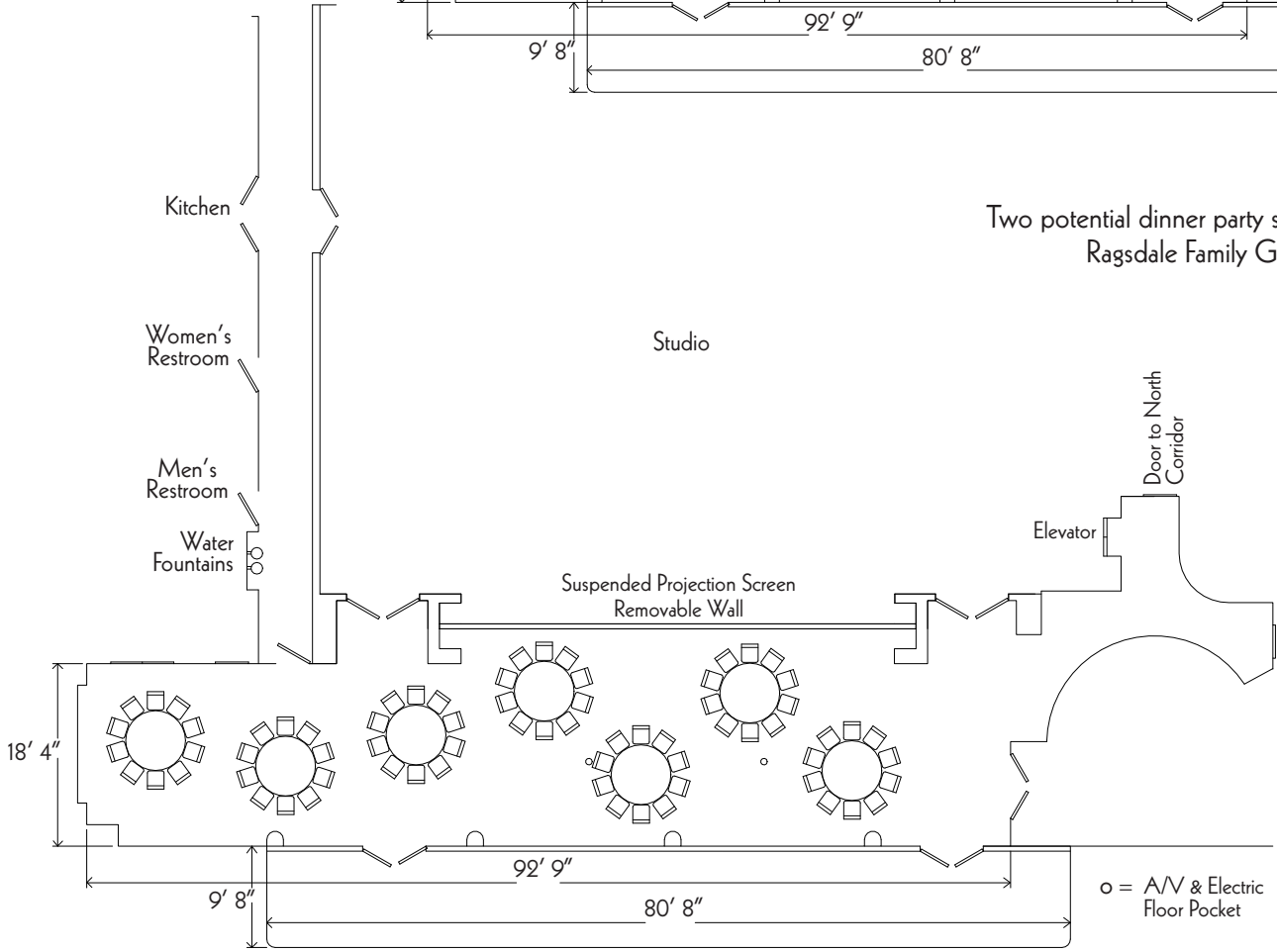

THE RAGSDALE FAMILY GRAND LOBBY

The Noah Liff Opera Center



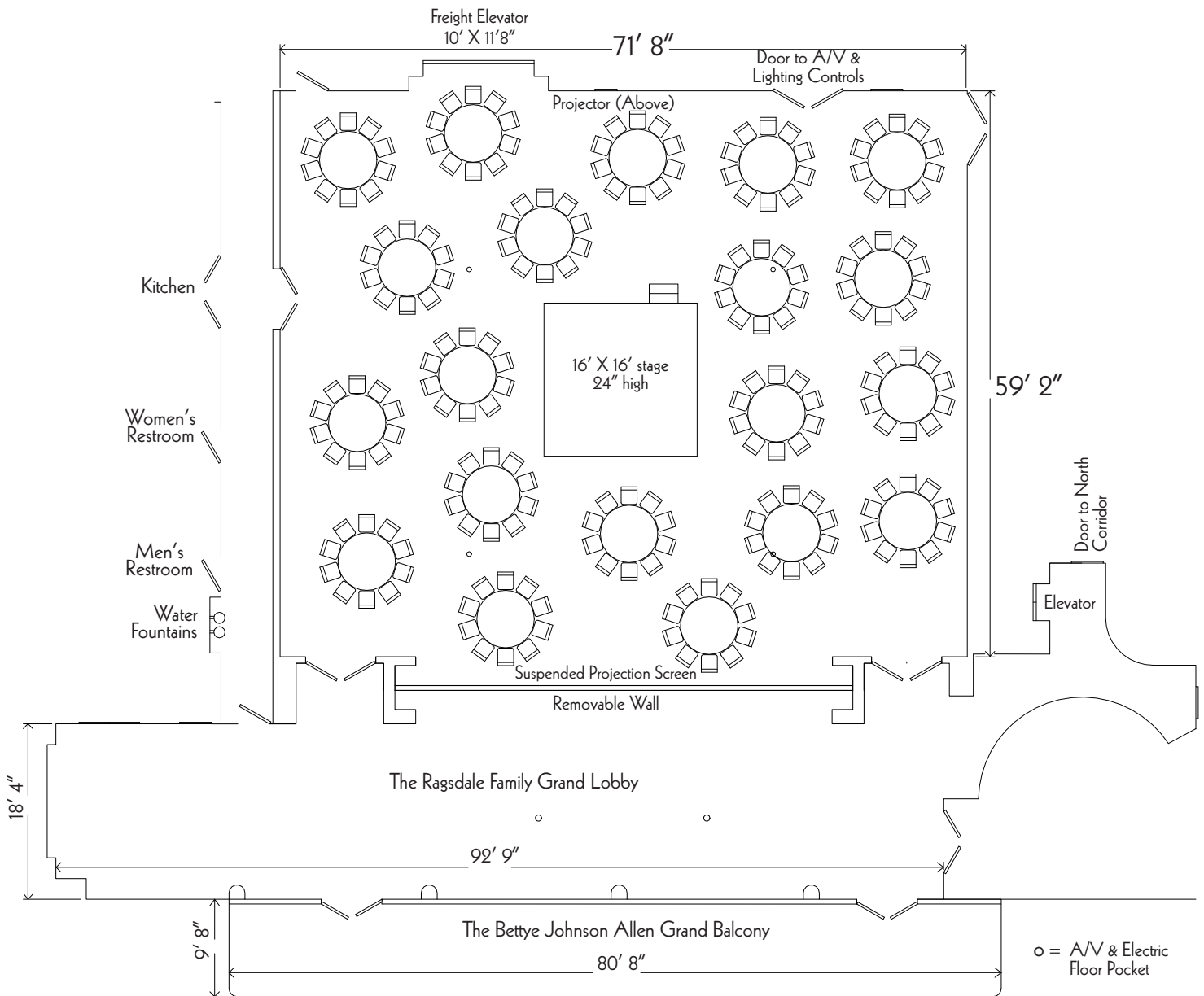

The versatile Studio can be arranged many ways, including this set-up for a dinner/concert in the round. In this diagram, seating for 200 is accomplished by 20 72-inch rounds. Comprehensive Audio/Video support and a full theatrical lighting system are available for any type of presentation.

The adjacent Ragsdale Family Grand Lobby and Bettye Johnson Allen Grand Balcony make a dramatic entry and additional party space.

THE OPERA STUDIO

The Noah Liff Opera Center

